

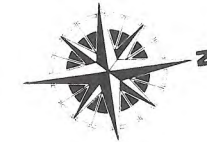

PIECES

IMMEUBLE A - ESC. 1

étage courant



SEJOUR	22,55
CHAMBRE	9,56
CUISINE	8,73
SANITAIRES	4,95
ENTREE-DEG ^t	3,99
PLACARDS	1,93

SURFACE HABITABLE : 51,71

BALCON 10,75

SURFACE TOTALE : m² 62,46

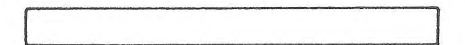

échelle : 1 m = 20 m/m

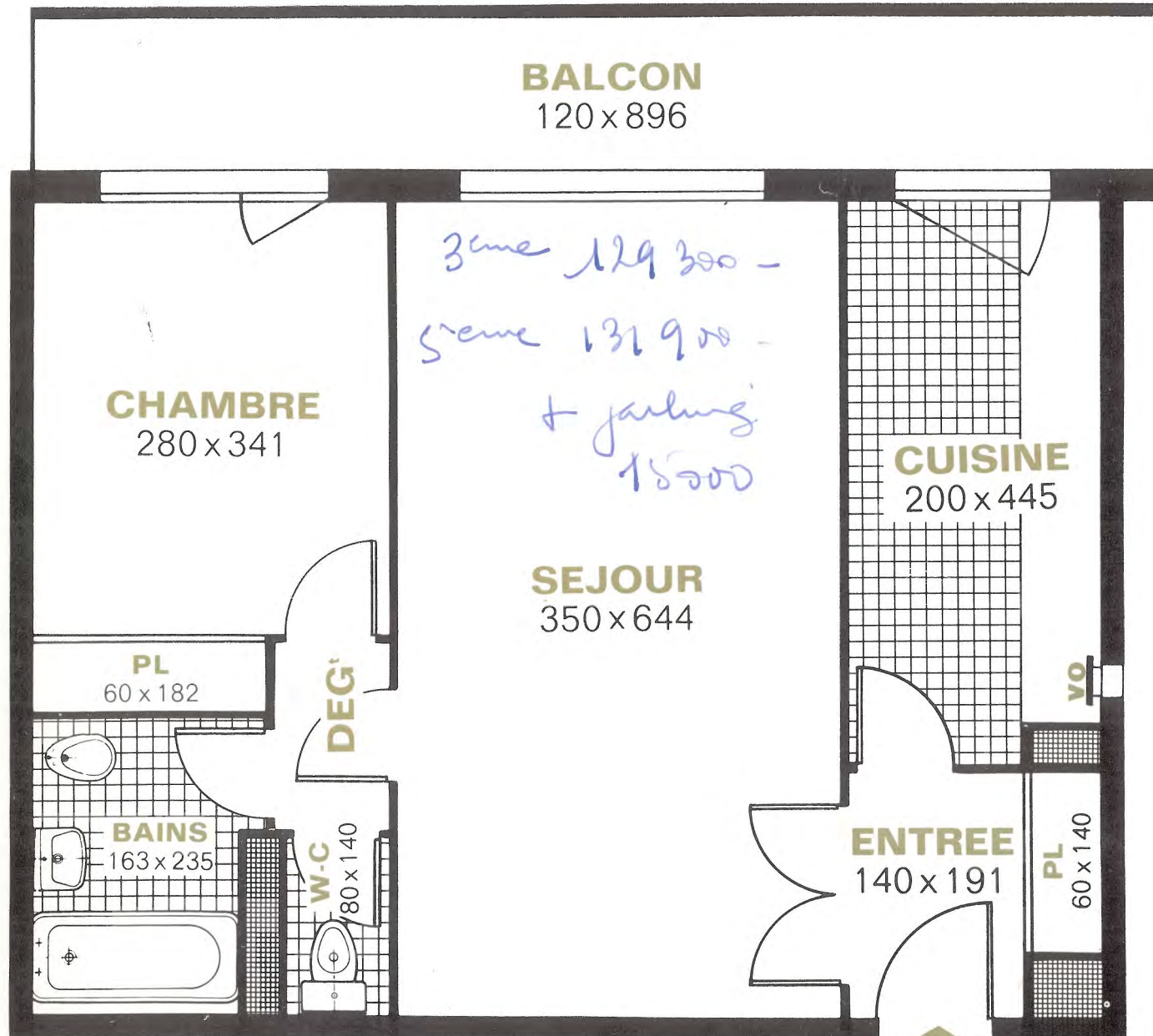

LES CONSTRUCTIONS
CHOISEUL
6, RUE DE HANOVRE - PARIS 7^e - TEL. 742.02.04